

Coca-Cola Turn Lane Design Portsmouth, OH

**HOWERTON
ENGINEERING &
SURVEYING PLLC**

Client

**Southern Ohio Growth
Partnership
P.O. Box 509
Portsmouth, Ohio 45622**

Key Staff

**Richard L. Howerton, PE, PS
Richard A. Howerton, PS
Carl Kibbey
Phillip Hammond**

In 2007 Howerton Engineering & Surveying was contracted to design turn lanes for the Coca-Cola proposed Industrial Park Access Road located in Clay Township in Scioto County, Ohio. The scope of the project consisted of:

- ◆ Topographic mapping of the US 23 corridor
- ◆ Coordinate meeting with the ODOT
- ◆ Geometric design of turn lanes for acceleration, deceleration, and storage
- ◆ Grading and drainage design for the proposed turn lanes
- ◆ preparation of plans and specifications
- ◆ Send plans to ODOT for approval

Project Cost

\$200,000

Project Completion Date

Pending

Project Budget

Pending

Project Schedule

Pending

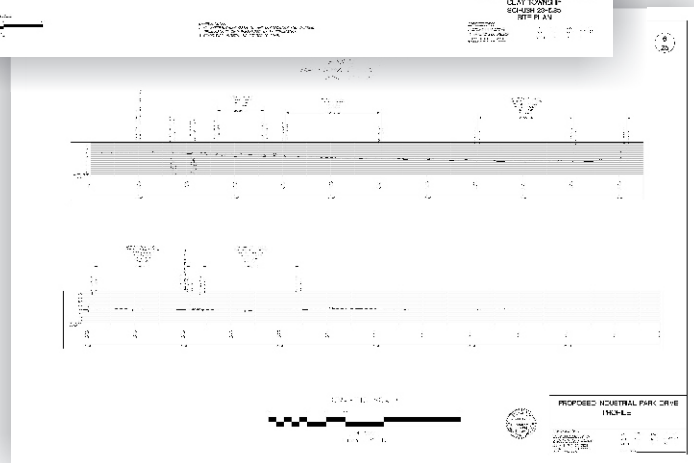
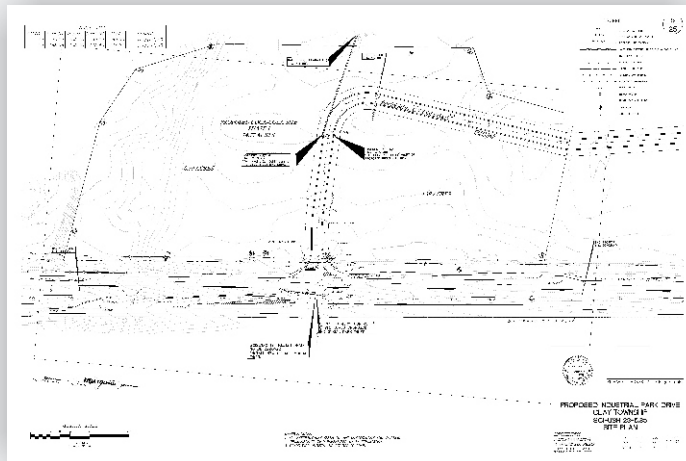

**HOWERTON
ENGINEERING &
SURVEYING PLLC**